

SECTION A - GEARCASE ASSEMBLY

ITEM NO.	DESCRIPTION	PART NO.	QTY
A	Case sub-assembly	MT0316	1
A1 & A2	Gearcase sub assembly - supplied complete only	MT0402	1
A3	Bolt	0041014	6
A4	Washer	0191710	11
A5 *	Gasket (top cover)	MT343	1
A6	Top cover	MT1467	1
A7	Screw	0040804	1
A8	Washer	CP1223	1
A9	Dipstick	MT472	1
A10	End cover	MT1267	1
A11	Screw	0041208	3
A12	Washer (spring)	0191107A	3
A14	Bolt	0041010	4
A15	Drain plug - magnetic	CP1331	1
A16	Washer	CP1068	1
A17	Eyebolt	CP1339	1
A18	Bolt	0041019	1
A19	Drain plug	0150100	1
A20	Washer	0201720	1
A21 *	'O' ring	0430771	1
A22	Breather	CP1383	1
A23	Locknut	CP1385	1
A24	Washer	CP1204	1
A25	Breather tube assembly	CP1382S/A	1
A26	Bonded washer	0201714	1
4:1 ratio only:-			
A1 & A2	Case sub-assembly - supplied complete only	MT0312	1
A9	Dipstick	0800925	1

* Part of gasket/seal kit MT0435

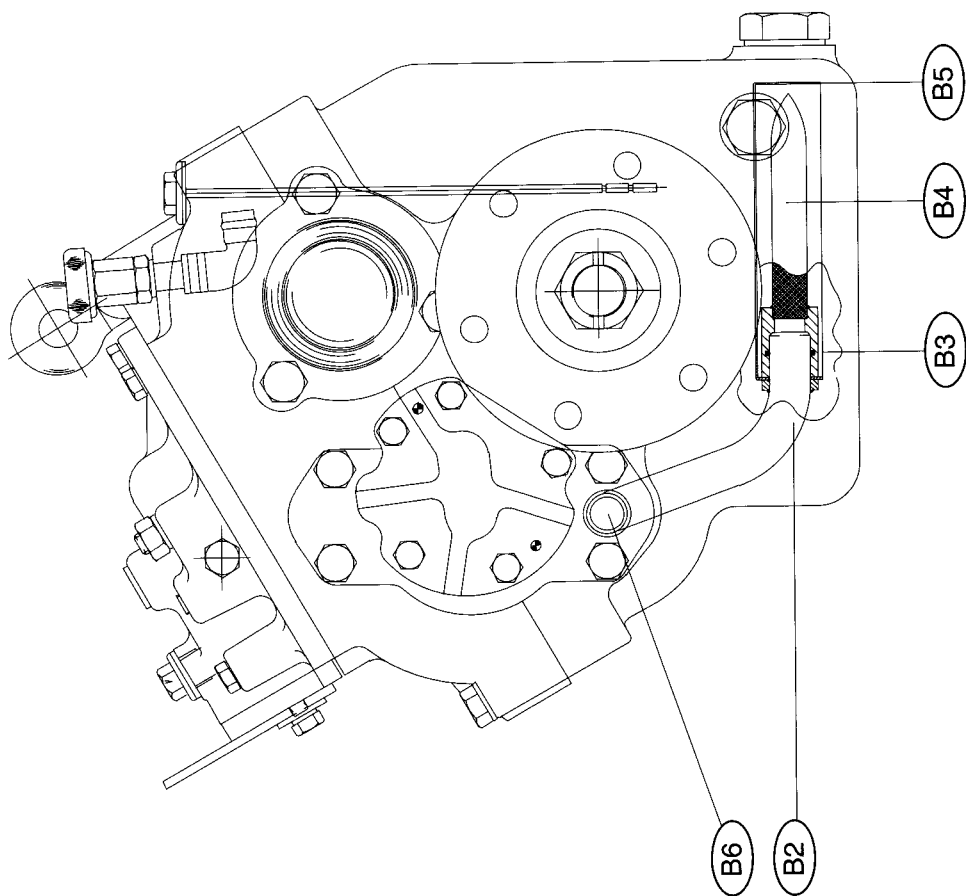
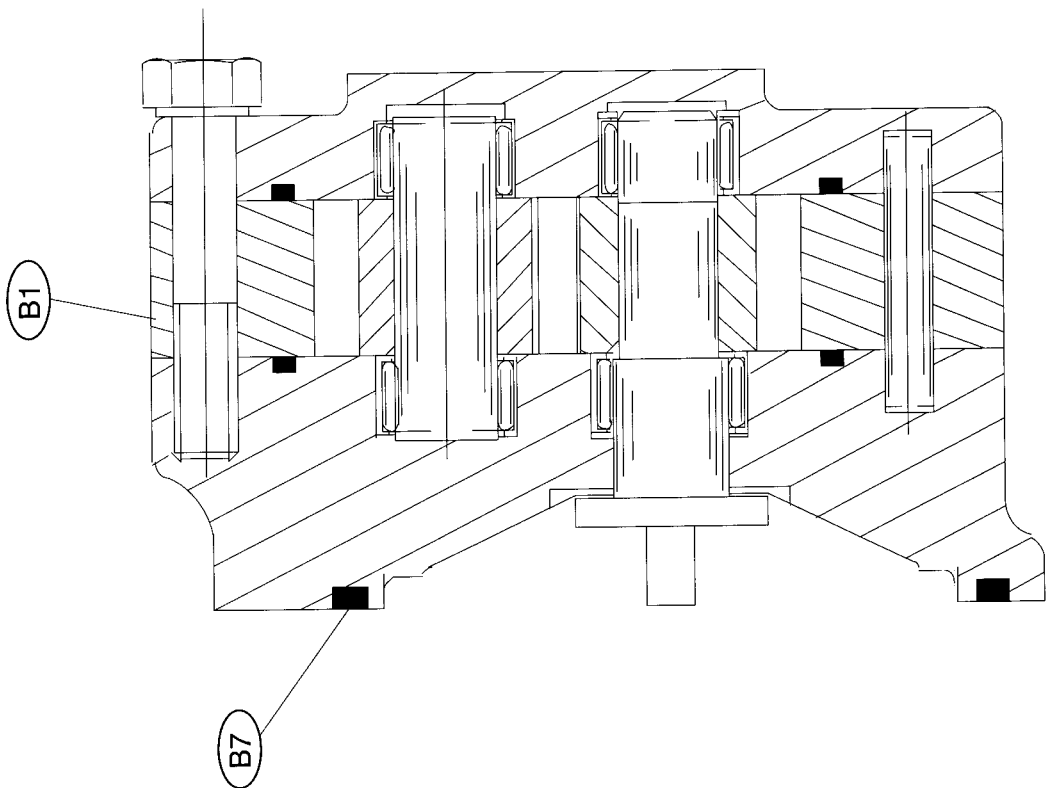

SECTION B - OIL PUMP ASSEMBLY

ITEM NO.	DESCRIPTION	PART NO.	QTY
B1	Oil pump (Kit)	MT0412-KIT	1
B2	Oil pipe	MT4945S/A	1
B2	Oil pipe 4:1 ratio only	MT4997S/A	1
B3 *	'O' ring	000872	1
B4	Strainer	MT4547	1
B5	Baffle	MT1504	1
B6 *	'O' ring	001254	2
B7 *	'O' ring	003383	1

* Part of gasket/seal kit MT0435

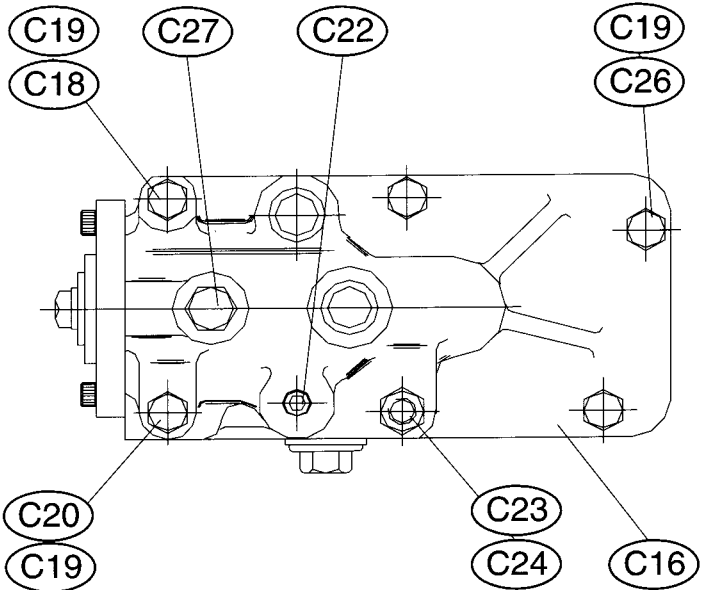
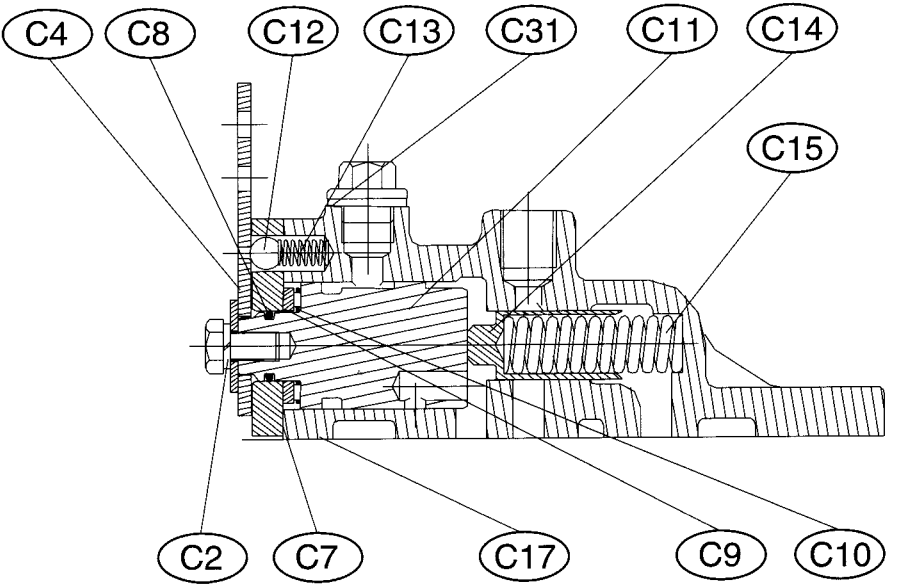
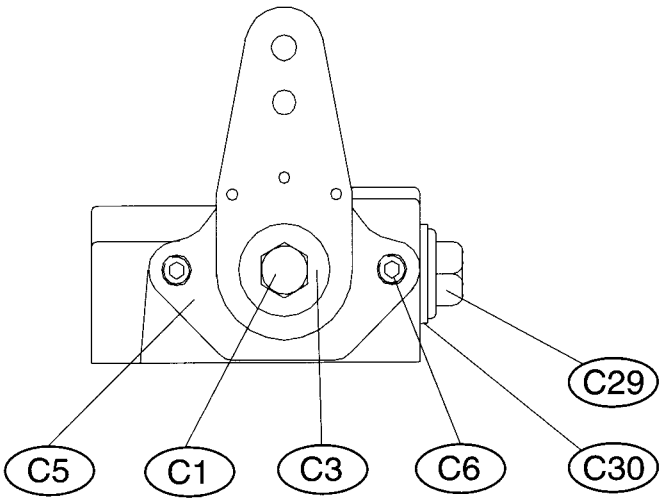

SECTION C - VALVE BLOCK ASSEMBLY

ITEM NO.	DESCRIPTION	PART NO.	QTY
C	Valve block assembly	MT0411	1
C1	Screw	0040806	1
C2	Spring washer	0191105	1
C3	Washer	MT979	1
C4	Operating lever	MT977	1
C5	End cover	MT978	1
C6	Cap screw	0081220	2
C7 *	Gasket	MT1081	1
C8 *	Nu-lip seal	MT8082	1
C9	Thrust race	CP1308	1
C10	Thrust bearing	CP1307	1
C11	Control valve	MT4656	1
C12	Detent ball	CP1077	1
C13	Detent spring	MT305	1
C14	Piston	MT4751	1
C15	Valve spring 3000 Kpa (440 psi)	MT4928	1
C16	Valve block	MT4780	1
C17 *	Gasket	MT1073	1
C18	Bolt	0040812	1
C19	Washer	CP1223	5
C20	Bolt	0040815	1
C21	Redcap seal (transit only)	MT477	2
C22	Pressure plug	MT311	1
C23	Nut	0051001	1
C24	Washer	0191710	1
C25	Stud	MT1292	1
C26	Screw	0040808	3
C27	Washer	0201715	1
C28	Plug	CP1360	1
or			
C28	Switch and ball assy	MT0214	1
C29	Bonded seal	0191718	1
C30	Plug (M18 pressure port)	0150318	1

* Part of valve block gasket kit MT0392 or gasket/seal kit MT0435

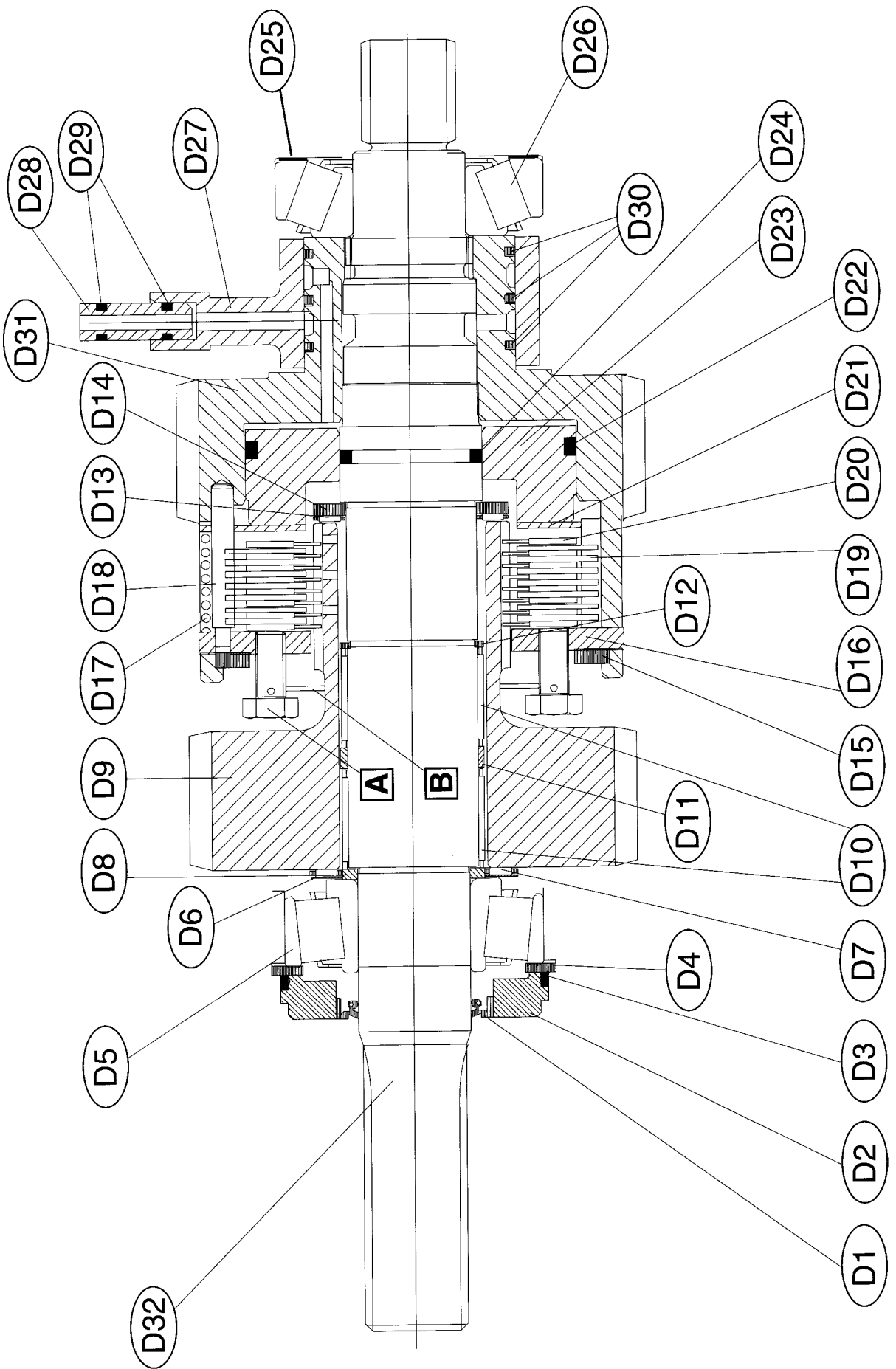

SECTION D - INPUT SHAFT ASSEMBLY

ITEM NO.	DESCRIPTION	PART NO.	QTY
D1 *	Oil seal - not used on 750A/C	MT251	1
D2	Oil seal housing - not used on 750A/C	MT1514	1
D3 *	'O' ring	04306725	1
D4	Thrust washer	MT1516	1
D5	Bearing cup	055U044	1
	Bearing cone	055C019	1
D6	Thrust washer	0673801	1
D7	Thrust bearing	0603801	1
D8	Spacer	MT1471	1
D9	Pinion (1:1) 43T	MT1582	1
D9	Pinion (1.5:1) 37T	MT1583	1
D9	Pinion (2:1) 31T	MT1475	1
D9	Pinion (2.5:1) 23T	MT1476	1
D9	Pinion (3:1) 21T	MT1477	1
D9	Pinion (4:1) 21T	MT1477	1
D10	Needle roller bearing	0563501	2
D11	Spacer	MT1472	1
D12	Snap ring	0300350	1
D13	Thrust bearing	0603501	1
D14	Thrust washer	0673503	1
D15 •	Circlip	0251020	1
D16 •	Clutch end cover	MT1484S/A	1
D17 •	Spring	MT1067	3
D18 •	Clutch pin	MT1485	3
D19 •	Clutch plate - driven	MT982	7
D20 •	Clutch plate - driver	MT725/S	8
D21 •	End plate	MT983	1
D22 *	Piston 'O' ring	003504	1
D23	Piston	MT1264	1
D24 *	Piston 'O' ring	0421503	1
D25 **	Shim 0.002"	MT1077/02	AR
	Shim 0.010"	MT1077/10	AR
	Shim 0.031"	MT1077/31	AR
D26	Bearing	0540302	1
D27	Feeder	MT380	1
D28	Feeder connector	MT1057	2
D29 *	Feeder 'O' ring	000372	4
D30 !	Piston ring	MT292	3
D31	Clutch gear RH (identification groove in teeth)	MT4853	1
D32	Input shaft	MT4935	1
	Input shaft (in-line only)	MT4944	1

• Part of clutch pack kit MT0349

* Part of gasket/seal kit MT0435

! Part of piston ring kit MT0439

** Part of shim kit MT0068

NOTE: AR as required.

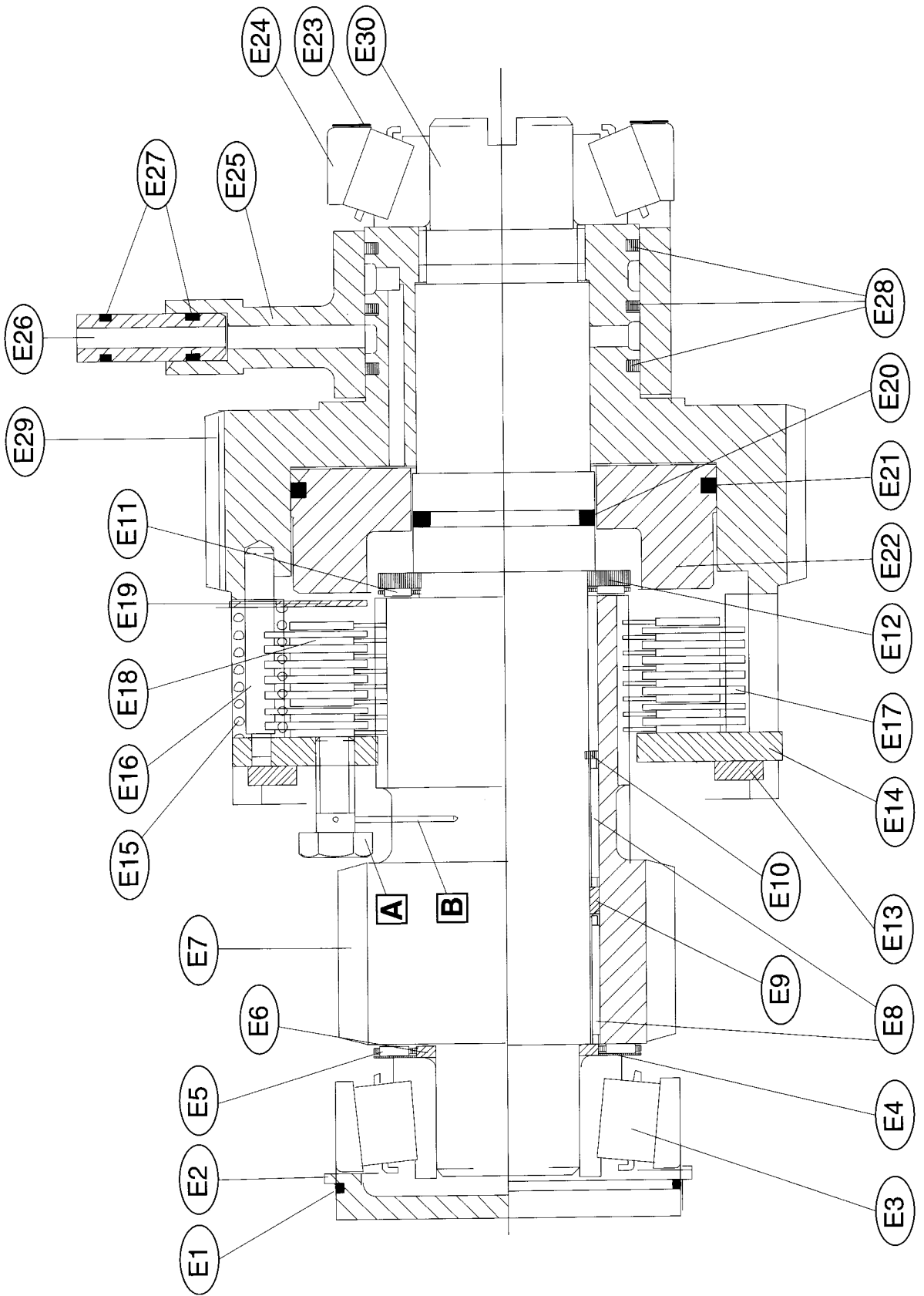

SECTION E - LAYSHAFT ASSEMBLY

ITEM NO.	DESCRIPTION	PART NO.	QTY
E1 *	'O' ring	04306725	1
E2	End cover	MT1515	1
E3	Bearing cup	055U044	1
	Bearing cone	055C019	1
E4	Thrust washer	0673801	1
E5	Thrust bearing	0603801	1
E6	Spacer	MT1471	1
E7	Drive pinion (1:1) 43T	MT1582	1
E7	Drive pinion (1.5:1) 37T	MT1583	1
E7	Drive pinion (2:1) 31T	MT1475	1
E7	Drive pinion (2.5:1) 23T	MT1476	1
E7	Drive pinion (3:1) 21T	MT1477	1
E7	Drive pinion (4:1) 21T	MT1477	1
E8	Needle roller bearing	0563501	2
E9	Spacer	MT1472	1
E10	Snap ring	0300350	1
E11	Thrust bearing	0603501	1
E12	Thrust washer	0673503	1
E13 •	Circlip	0251020	1
E14 •	Clutch end cover	MT1484S/A	1
E15 •	Spring	MT1067	3
E16 •	Clutch pin	MT1485	3
E17 •	Clutch plate - driven	MT982	7
E18 •	Clutch plate - driver	MT725/S	8
E19 •	End plate	MT983	1
E20 *	Piston 'O' ring	0421503	1
E21 *	Piston 'O' ring	003504	1
E22	Piston	MT1264	1
E23 **	Shim 0.002"	MT1077/02	AR
E23 **	Shim 0.010"	MT1077/10	AR
E23 **	Shim 0.031"	MT1077/31	AR
E24	Bearing	0540302	1
E25	Feeder	MT380	7
E26	Feeder connector	MT1057	2
E27 *	Feeder 'O' ring	000372	4
E28 !	Piston ring	MT292	3
E29	Clutch gear LH	MT4854	1
E30	Layshaft	MT1500	1

• Part of clutch pack kit MT0349

! Part of piston ring kit MT0439

* Part of gasket/seal kit MT0435

** Part of shim kit MT0068

NOTE: AR as required.

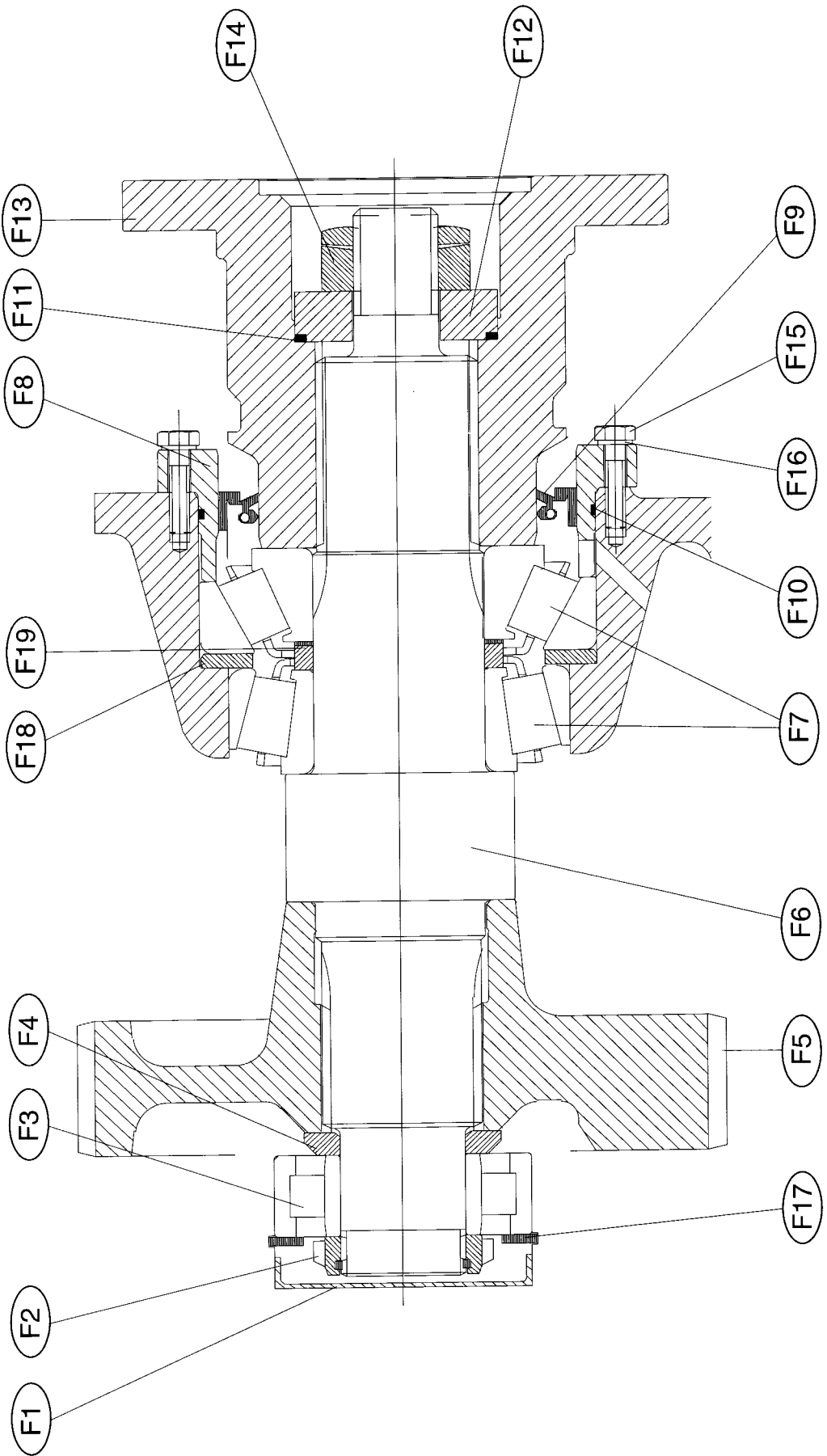

SECTION F - OUTPUT SHAFT ASSEMBLY

ITEM NO.	DESCRIPTION	PART NO.	QTY
F1 *	Shamban seal - not used with 750A/C	06907209	1
F2	Locknut	CP1406	1
F3	Bearing	0533532	1
F4	Spacer	MT4925	1
F5	Output gear 1:1 47T	MT4917	1
	Output gear 1.5:1 54T	MT4918	1
	Output gear 2:1 60T	MT4919	1
	Output gear 2.5:1 59T	MT4920	1
	Output gear 3:1 61T	MT4828	1
	Output gear 4:1 83T	MT4927	1
F6	Output shaft	MT4827	1
F7	Bearing assembly (incl. F18/F19)	MT0455	1
F8	Seal housing (incl. seal F9)	MT4943S/A	1
F9 *	Output seal	0400781	1
F10 *	'O' ring	0431071	1
F11 *	'O' ring	04305025	1
F12	Coupling washer	MT4947	1
F13	Output coupling	MT4829	1
F14	Locknut	0472410ZP	1
F15	Screw	0040608HTZP	8
F16	Spring washer	0191104ZP	8
F17	Circlip	CM2077	1
F18	Spacer	} Part of Assembly F7	1
F19	Shim washer		1

* Part of gasket/seal kit MT0435

NOTE: Item F7 bearing assembly is only sold complete. It is a factory adjusted item and cannot be purchased as individual parts.

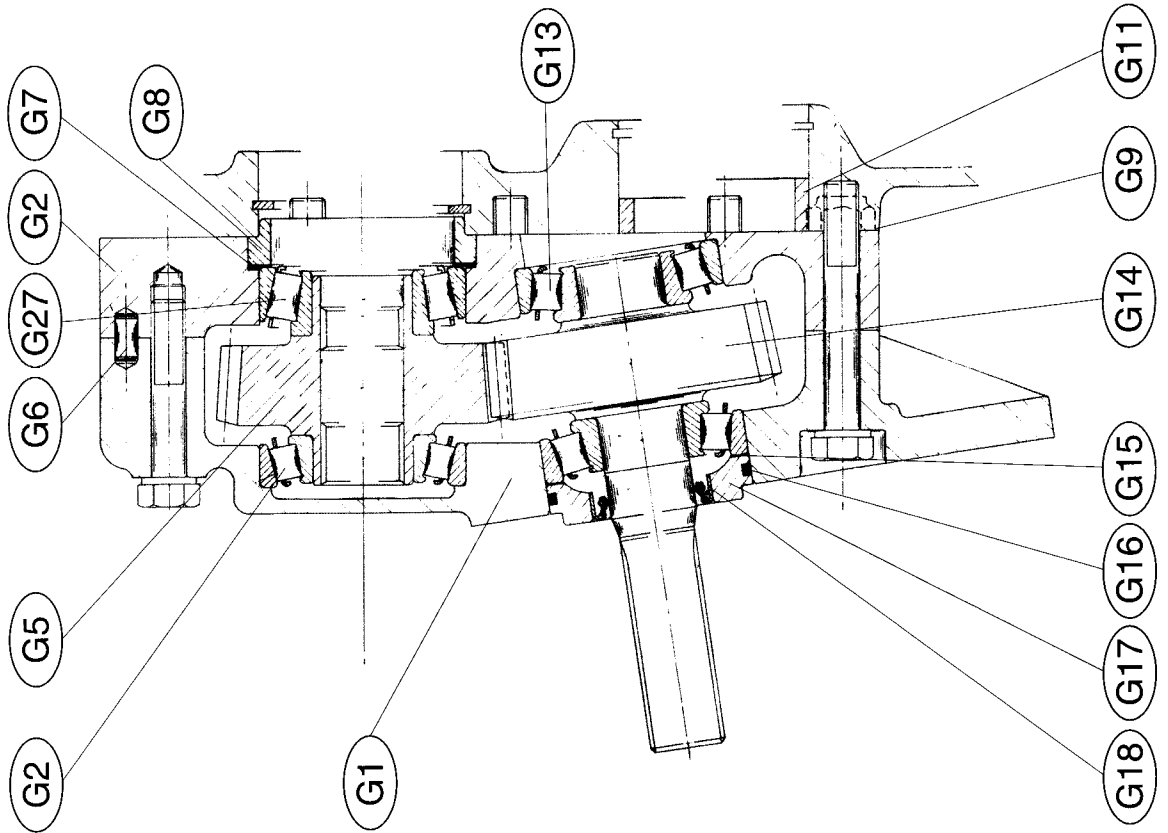
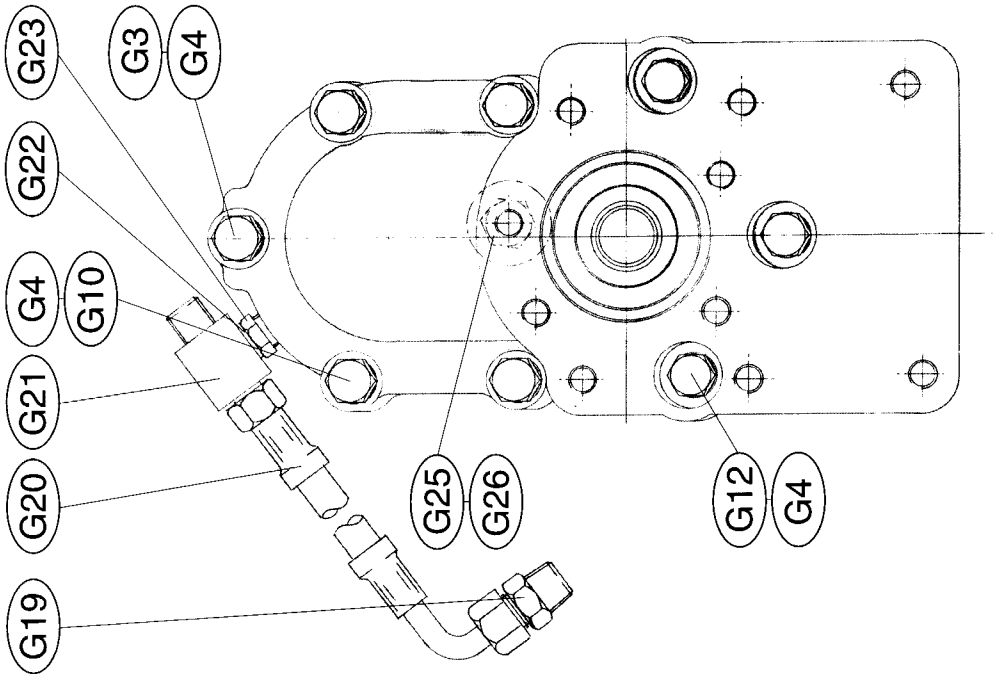

SECTION G - DOWN ANGLE DRIVE UNIT

ITEM NO.	DESCRIPTION	PART NO.	QTY
G	Down angle drive unit	MT0210	1
G1	Gearcase S/A	MT0189	1
	Half case (front) - not supplied separately	MT1273	1
	Half case (rear) - not supplied separately	MT1274	1
G2	Taper roller bearing	0540351	1
G3	Bolt	0041216	1
G4	Dowty seal washer	CP1204	8
G5	Output Gear	MT1527	1
G6	Dowel	0210815	2
G7	Shim 0.002"	057313A	AR
	Shim 0.10"	057313C	AR
	Shim 0.031"	057313E	AR
G8	Location ring	MT1512	1
G9	Gasket	MT1281	1
G10	Bolt	0041222	4
G11	Spacer	MT1271	1
G12	Bolt	0041221	3
G13	Taper roller bearing	0540302	2
G14	Input gear	MT1525	1
G15 **	Shim 0.002"	MT1077/02	AR
G15 **	Shim 0.010"	MT1077/10	AR
G15 **	Shim 0.031"	MT1077/31	AR
G16 *	'O' ring	002874	1
G17	End cover	MT1068	1
G18 *	Oil seal	MT251	1
G19	Adaptor	CP1255	1
G20	Oil pipe	MT766	1
G21	Tee piece	CP1367	1
G22	Washer	0201715	1
G23	Metering union	MT4583	1
G25	Washer - transit only	CM2123	
G26	Screw - transit only	0041206	
G27	Taper bearing	0540353	1

* Part of gasket/seal kit MT0435

** Part of Shim Kit MT0068

NOTE: AR as required.

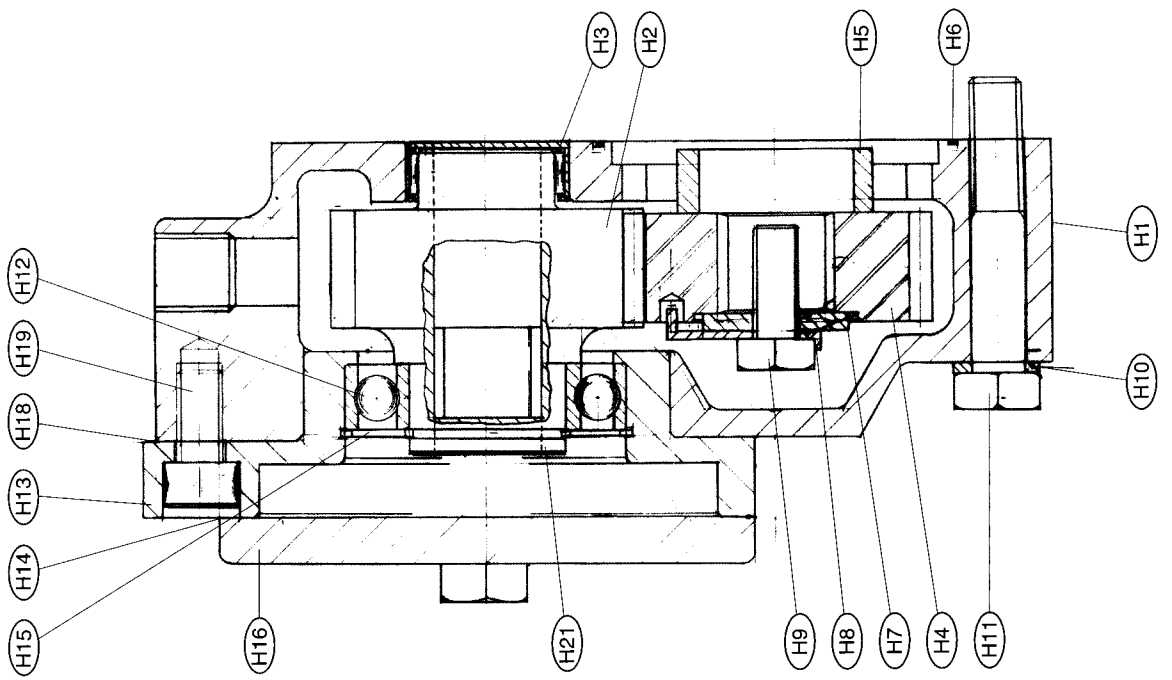
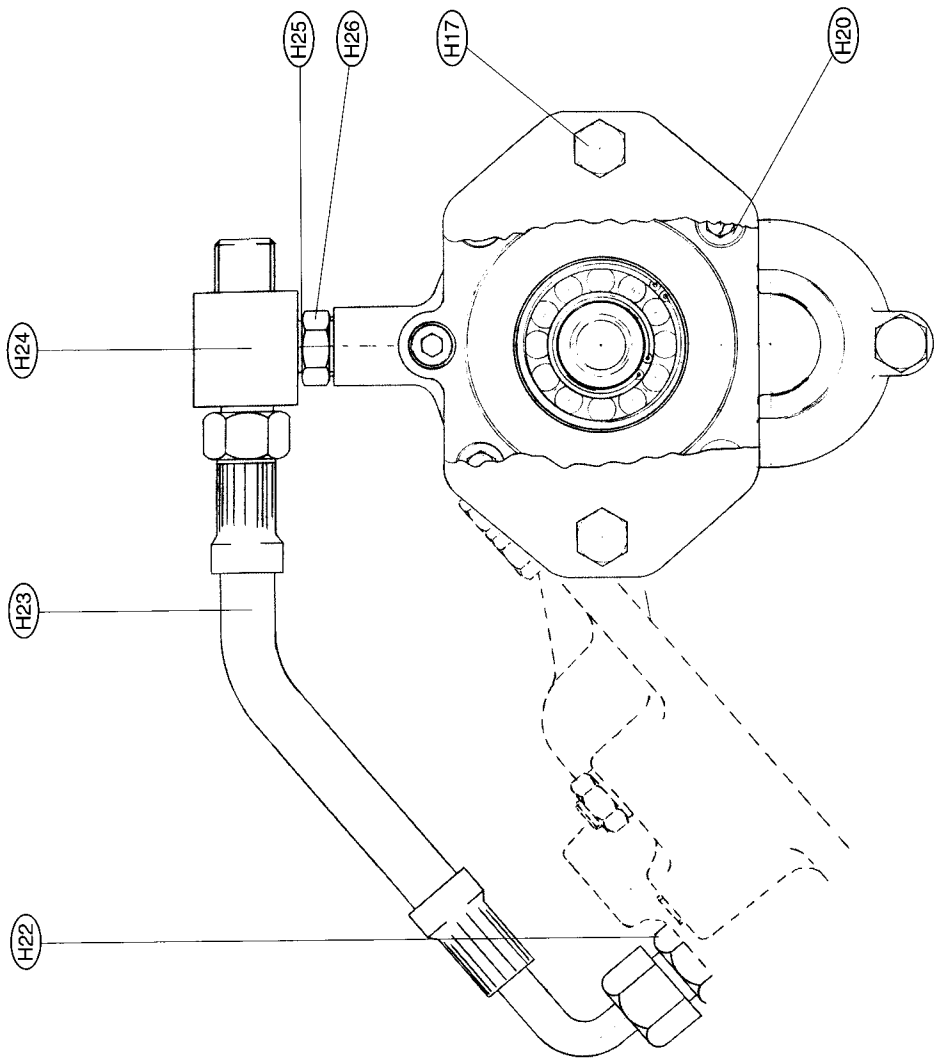

SECTION H - POWER TAKE-OFF

ITEM NO.	DESCRIPTION	PART NO.	QTY
H	Power Take-Off	MT0193	1
H1	PTO housing	MT1300	1
H2	Driven gear	MT1297	1
H3	Needle bearing	0563003	1
H4	Driving gear	MT1296	1
H5	Spacer	MT1589	1
H6 *	'O' ring	0430771	1
H7	Washer	MT1301	1
H8	Tab washer	MT1302	1
H9	Screw	0041008	1
H10	Spring washer	0191107	3
H11	Bolt	0041216	1
H12	Ball bearing	40M433	1
H13	Adaptor flange	MT1299	1
H14	Gasket 4 bolt	MT1307	1
H14	Gasket 2 bolt	MT5012	1
H15	Circlip	0250620	1
H16	Cover plate - transit only	MT1293	1
H17	Screw	0041208	2
H18	Gasket	MT1303	1
H19	Cap screw	0081520	1
H20	Cap screw	0081685	2
H21	Circlip	CM2067	1
H22	Adaptor	CP1255	1
H23	Oil pipe	MT766	1
H24	Tee piece	CP1367	1
H25	Washer	0201715	1
H26	Metering union	MT4583	1

* Also part of gasket/seal kit MT0435

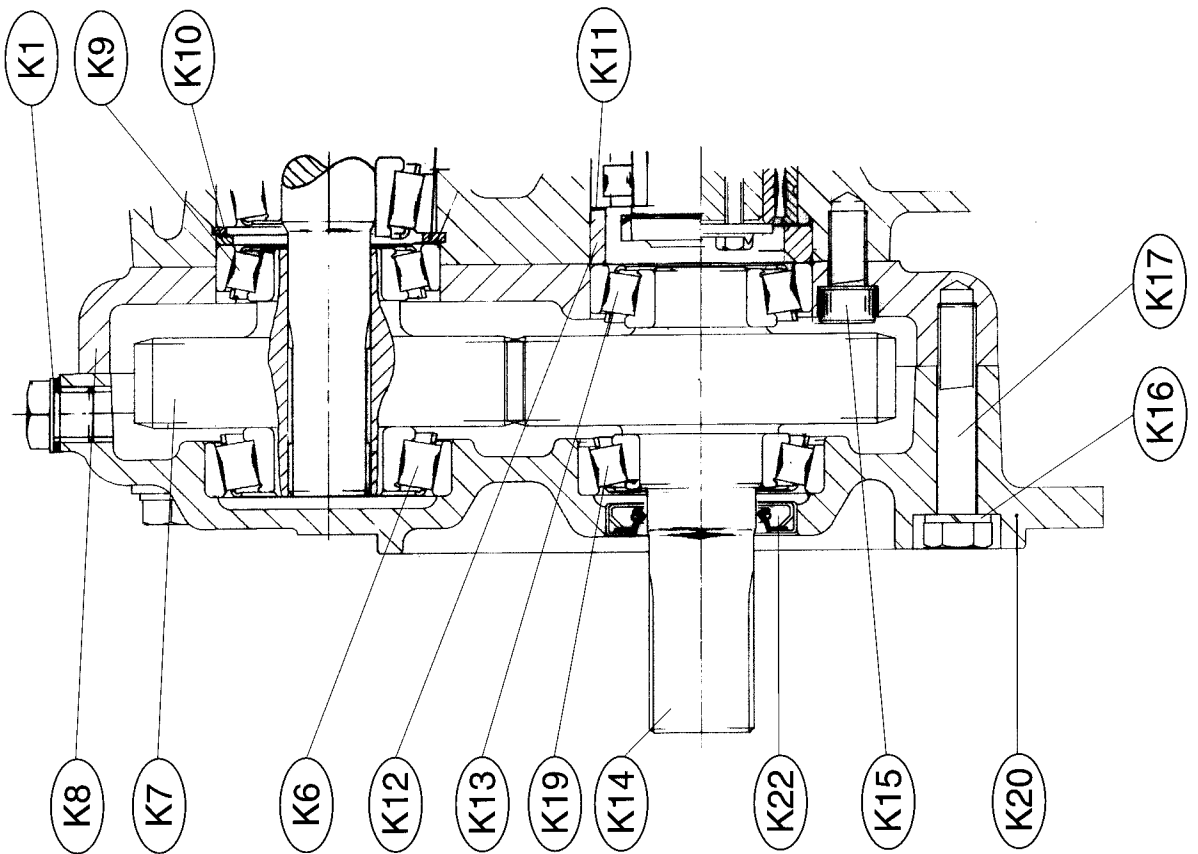
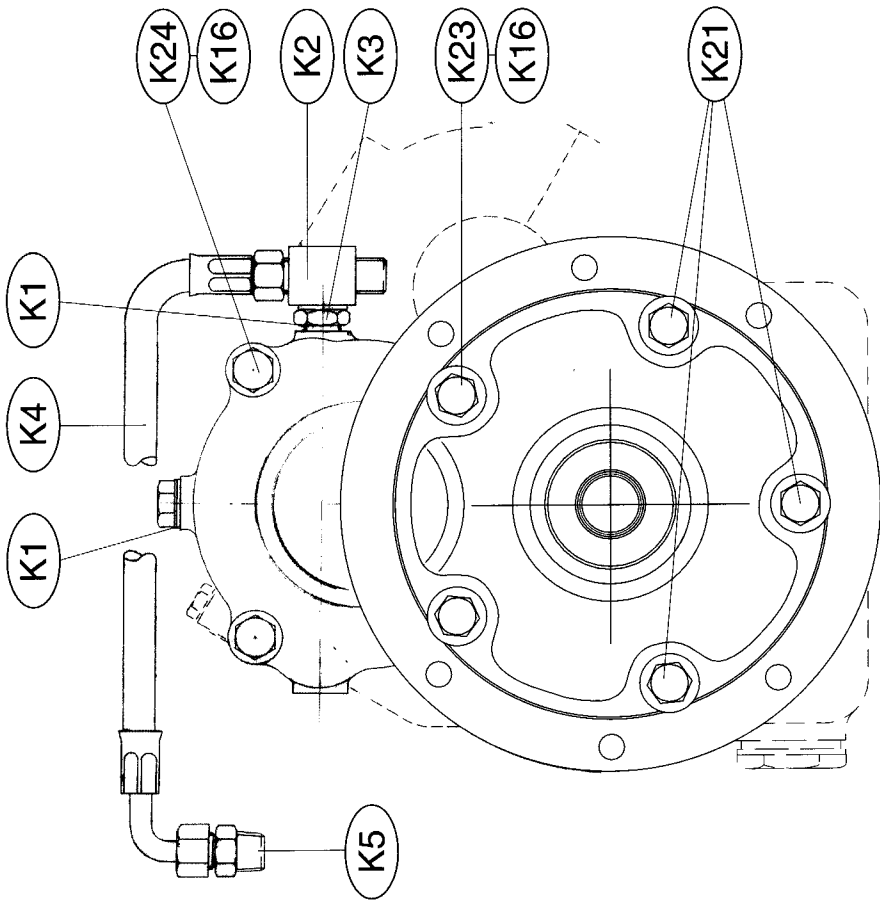

SECTION K - IN-LINE UNIT

ITEM NO.	DESCRIPTION	PART NO.	QTY
K	In-line unit	MT0279	1
K1	Dowty washer	0201715	2
K2	Tee piece	CP1367	1
K3	Metering union	MT4583	1
K4	Oil pipe	MT767	1
K5	Adaptor	CP1255	1
K6	Bearing	0540354	1
K7	Gear 45T LH	MT1435	1
K8	Gearcase	MT1433	1
K9	Bearing	0540351	1
K10	Spacer	MT1465	1
K11 **	Shim 0.002"	MT1077/02	AR
K11 **	Shim 0.010"	MT1077/10	AR
K11 **	Shim 0.031"	MT1077/31	AR
K12	Spacer	MT1400	1
K13	Bearing	0540301	1
K14	Gear and shaft - 45T RH	MT1434	1
K15	Socket head screw	0081620	1
K16	Spring washer	0191107	11
K17	Bolt	0041208	4
K18	Dowel - not illustrated	0210614	2
K19	Bearing	0540402	1
K20	Gearcase	MT1432	1
K21	Bolt	0041217	3
K22	Oil seal	0400351	1
K23	Bolt	0041222	2
K24	Bolt	0041215	2
	NOTE: Input shaft of main gearbox becomes	MT4944	1

** Part of shim kit MT0068

NOTE: AR as required.